

Year 6

School Phased 'Re-opening'

at

**Northern Parade (Federated)
Infant & Junior Schools**
(King's Group Academies)



How to ensure that we all are safe
on school re-opening during COVID-19.



IMPORTANT INFORMATION –

Please carefully read this leaflet so that we can ensure that everyone in our school community remains as safe as possible.

What will we be doing to keep children safe?

- The children will be in a group – a Bubble Group, they will stay in this small group for the day; including playtime, lunchtime. They will not mix with children from other groups as far as possible.
- Children will follow one-way systems when moving from their class bubble base to the playground.
- Pupils may not be with their own class teacher, or year group support staff. It will however be a member of the Junior staff.
- Children will remain in the same class base.
- Children will have their own desk which will face the front of the class room and they will not wander around.
- Children will be undertaking activities that are very similar to the ‘Home Learning’ activities.
- Children will have their own personal set of resources that will remain on their table throughout the day.
- Classrooms will be cleared of unnecessary equipment.
- Bins will be emptied regularly throughout the day.
- All class bases will be well ventilated using natural ventilation ie open doors and windows.
- Children will wash hands regularly ensuring that this is carried out for 20 seconds each time. Adults will assist and help children at all times from a distance.
- Classrooms will be thoroughly cleaned daily and at the end of the morning and after lunch time.
- Children will only use allocated toilets in order to reduce contact with children from other Bubble Groups.
- Children will be supported at all times regardless of need – emotionally/socially.
- Parents will not be able to enter the school grounds.
- Morning drop off and end of school collection times will be staggered but there will be staff on hand to assist children and parents to ensure that the children are safe and happy.
- Children do not need to bring book bags to school, pencil cases or anything additional where at all possible.

Why we are taking these measures?

- By returning pupils gradually to school we can put in place the necessary protective measures that will ensure that the children are safe and happy.
- Evidence has shown that by following strict social distancing measures, the transmission rate of (COVID-19) has decreased. It is essential that we continue to do so.



How should parents bring & collect their children?

- The children will be given times to arrive and leave school.
- These times must be kept to, in order to ensure safety.
- Children will be assigned a gate from which to enter by and leave by. These will be either the Year 3 gate or the Year 4 gate (which is accessed through the far end of the staff car park nearest which will not be in use & manned by staff).
- Members of staff will be at the gate and will direct children towards their classrooms.
- Parents will not be able to enter the school premises so will have to drop off and collect at the gates.
- Only one parent should drop off their child.
- It is highly preferable for parents to bring and collect their children from school. Any child walking to school on their own must remember to observe social distancing.

What will the classrooms look like?

- The children will sit at their own individual table.
- Their belongings will stay on their own table, coat on the back of their own chair.
- No P.E. kit is required.
- Tables have been spaced as far away from each other as possible.
- We have decided that there will be no more than 12 children in a Year 6 bubble classroom.



What about when children remain at home?

- We will still be providing work, responding to work and live lessons on Google Classroom.
- Members of staff from Year Six will be overseeing Google Classroom and will be able to respond.
- We will aim to match the activities at school to 'working at home' activities.

Where should I bring and collect my child?



Year 4 gate



Main gate to Yr 3 gate

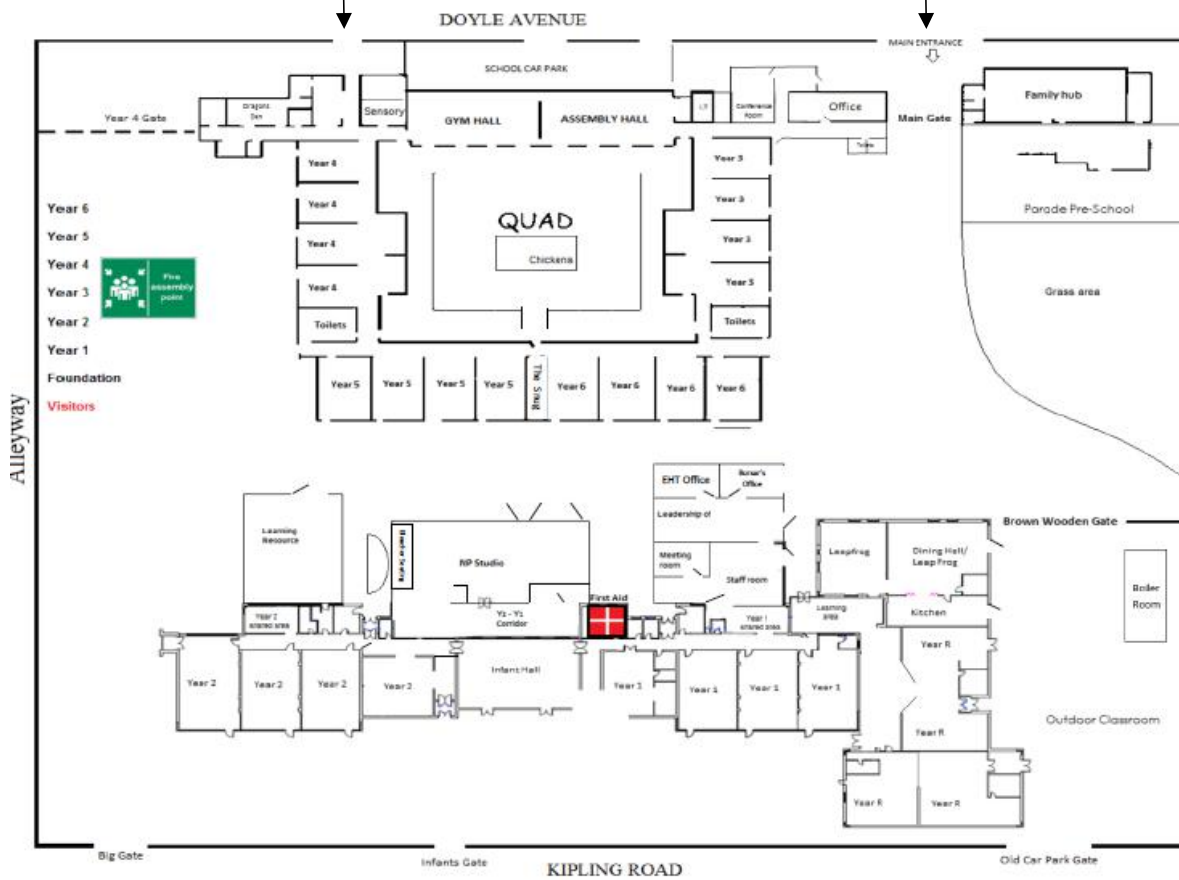

- We will contact you individually to advise you:
 - which class 'Bubble' your child will be in
 - which gate they should enter and exit from
 - what times they must arrive and leave
 - which member of staff they will be working with for most of the time (Monday to Thursday).