

Year R

School Phased 'Re-opening'

at

**Northern Parade (Federated)
Infant & Junior Schools**
(King's Group Academies)



How to ensure that we all are safe
on school re-opening during COVID-19.



IMPORTANT INFORMATION –
Please carefully read this leaflet so that we can
ensure that everyone in our school community
remains as safe as possible.

What will we be doing to keep children safe?

- The leadership team will make every effort to ensure that pupils follow the government guidance
- The children will be in a group – Bubble Group, they will stay in this small group for playtime, lunchtime. They will not mix with children from other groups.
- Children will follow one way systems when moving from class base to their allocated playground.
- Pupils may not be with their class teacher, or year group support staff. It will however be a member of year 1 or 2 staff.
- Children will remain in the same class base 'room with their 'bubble'.
- Children will spend an increased amount of time outside where possible.
- Children will have their own desk which will face the front of the class room and they will not wander.
- Children will be doing activities that are very similar to the 'Home Learning' activities.
- Children will have their own personal set of resources that will remain on their table throughout the day.
- Classrooms will be cleared of unnecessary equipment.
- Bins will be emptied regularly throughout the day.
- All class bases will be well ventilated using natural ventilation.
- Children will wash hands regularly ensuring that this is carried out for 20 seconds each time. Adults will assist and help children at all times from a distance.
- Classrooms will be thoroughly cleaned daily and at the end of the morning and after lunch time.
- Children will only use allocated toilets in order to reduce contact with children from other 'Bubble Groups'.
- Children will be supported at all times regardless of need – emotionally/socially
- Children will not take part I school assemblies.
- Parents will not enter the school grounds.
- Morning drop off and end of school collection times will be staggered but there will be staff on hand to assist children and parents to ensure that the children are safe and happy.
- Children do not need to bring book bags to school, pencil cases or anything additional where at all possible.

Why we are taking these measures?

- By returning pupils gradually to school we can put in place the necessary protective measures that will ensure that the children are safe and happy.
- Evidence has shown that by following strict social distancing measures, the transmission rate of (COVID-19) has decreased. It is essential that we continue to do so.



How should parents bring & collect their children?

- Morning drop off and collection times will be staggered.
- Each 'Bubble Group' will be given an allocated time for the morning and afternoon.
- With the allocated time slot there will be an allocated gate.
- Parents will be asked to use the allocated time only.
- In order to assist 'social distance' parents will be asked to line up from the right or left side of the gate entrance.
- Parents will be asked to move quickly from the gate entrance to allow the flow of children to get to their class base quickly and safely.
- Members of staff will be at hand to assist parents at all times.
- Only one parent to drop off and pick up.
- Parents will be asked not to gather round the school gates.

What will the classrooms look like?

- The children will sit at their own individual table.
- Their belongings will stay on their own table, coat on the back of their own chair.
- No P.E. kit is required.
- Tables have been spaced as far away from each other as possible.
- We have decided that there will be no more than 10 children in a Year R bubble classroom.



What about when children remain at home?

- Children at home will still be able to access home learning activities from the website.
- These will be updated weekly by class teachers from the Foundation year group.
- In addition to this the children will be able to access learning activities via 'Google Classroom'.
- Class teachers will still make regular contact through 'Marvelous Me' posting additional activities related to the topic.

Where should I bring and collect my child?

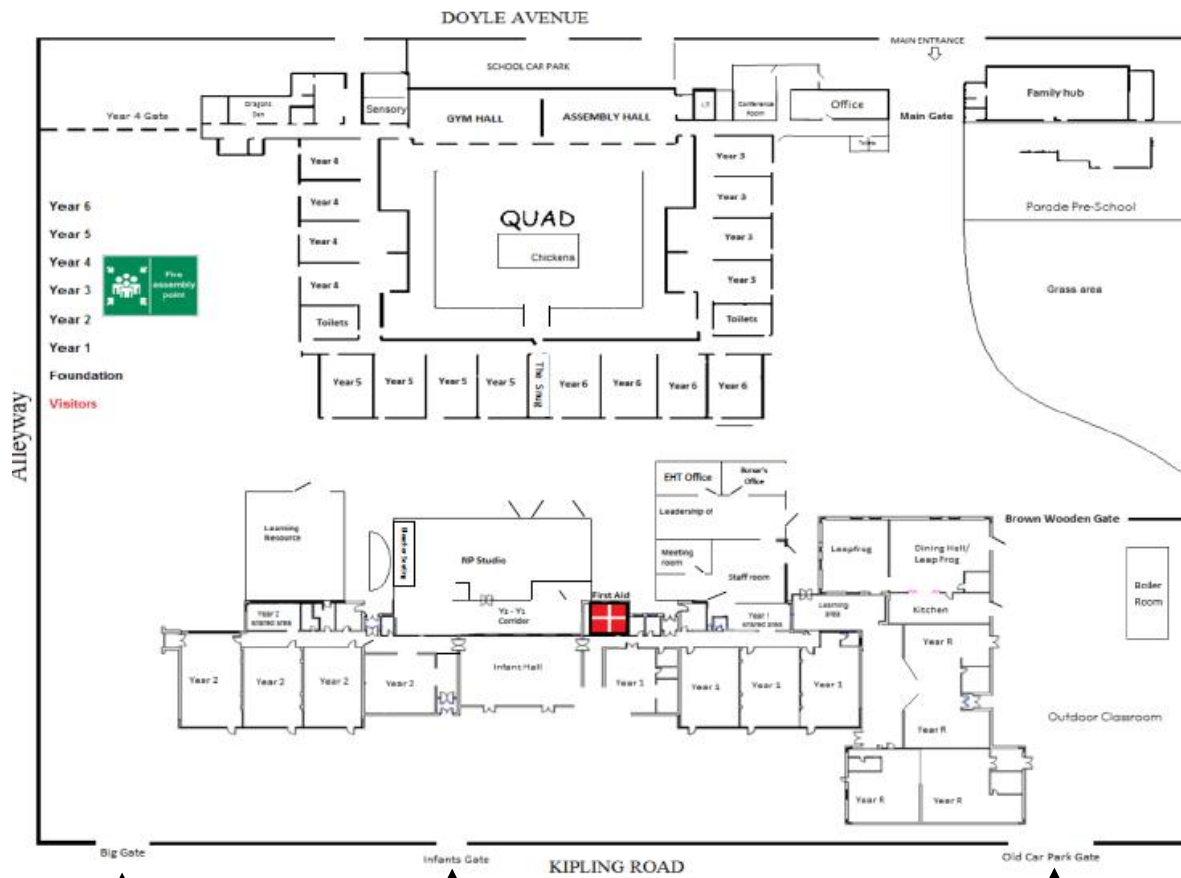

End gate

Main infant gate

Year R outside gate



- We will contact you individually to advise you:
 - which class 'Bubble' your child will be in
 - which gate they should enter and exit from
 - what times they must arrive and leave
 - which member of staff they will be working with for most of the time (Monday to Thursday).